

MAP OF COMPETITION SITES

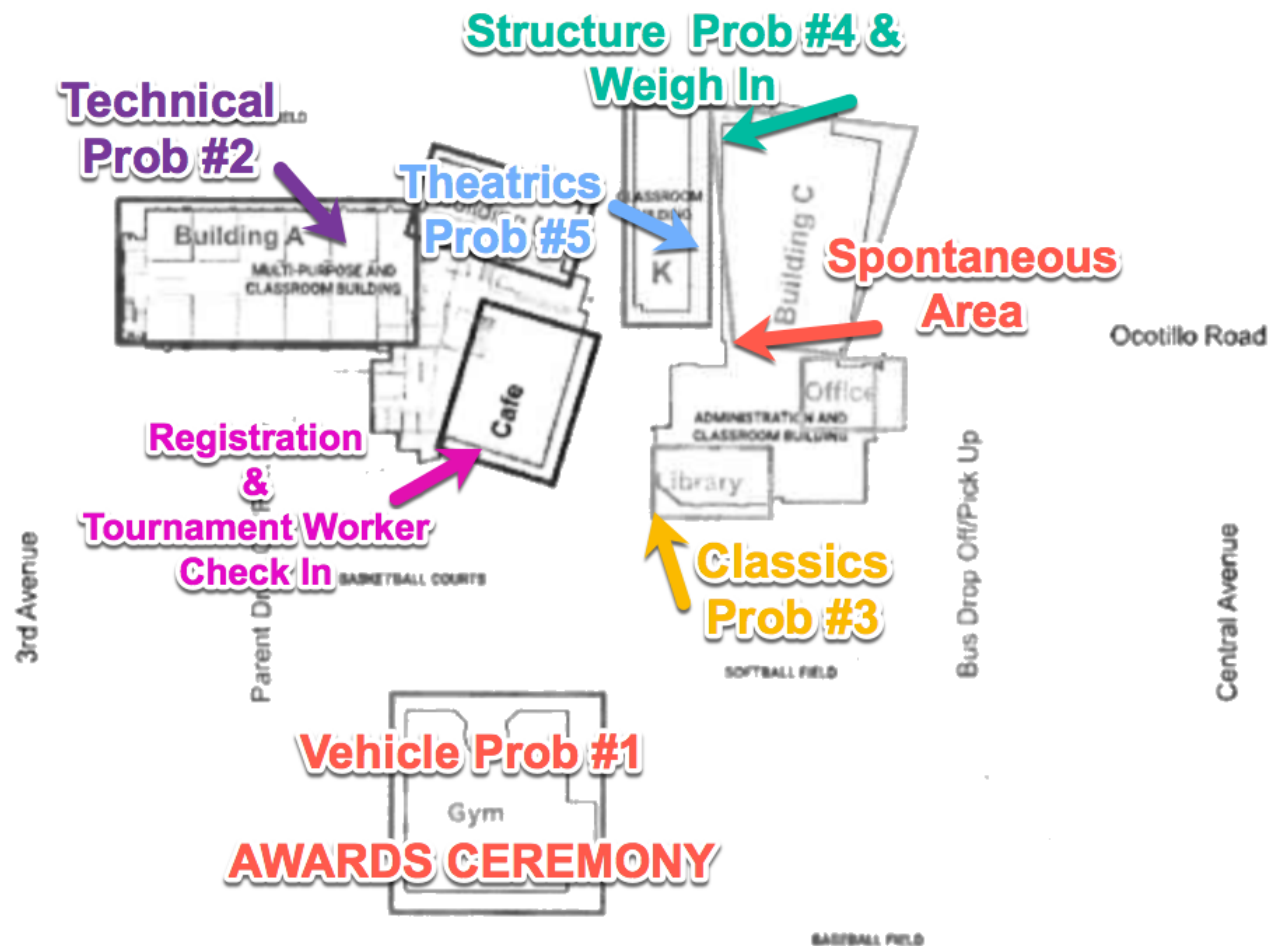

VEHICLE PROBLEM #1 - DRIVE-IN MOVIE

Gym

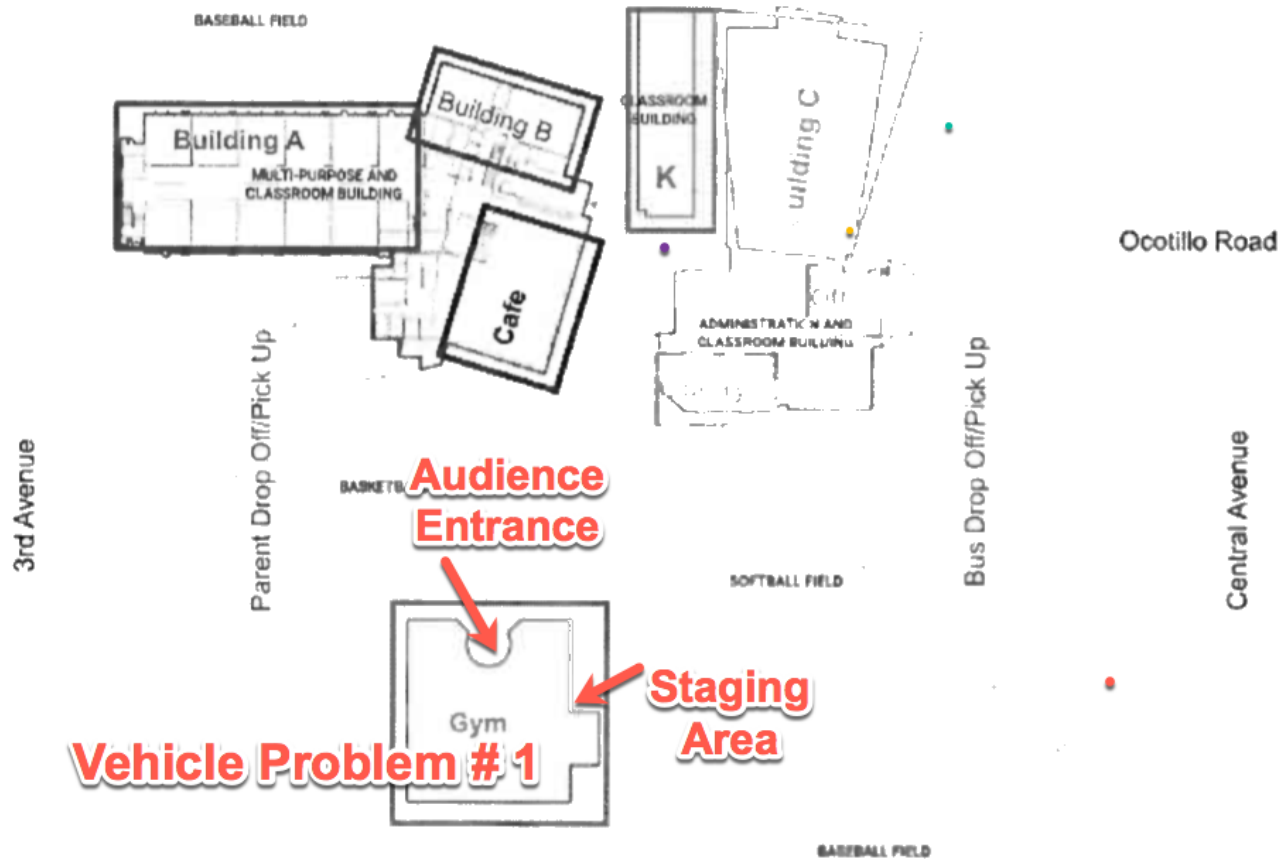

TECHNICAL PROBLEM #2 – AI TECH-NO-ART

Building A – Room A111 (enter Staging Area at the back of the Cafeteria)

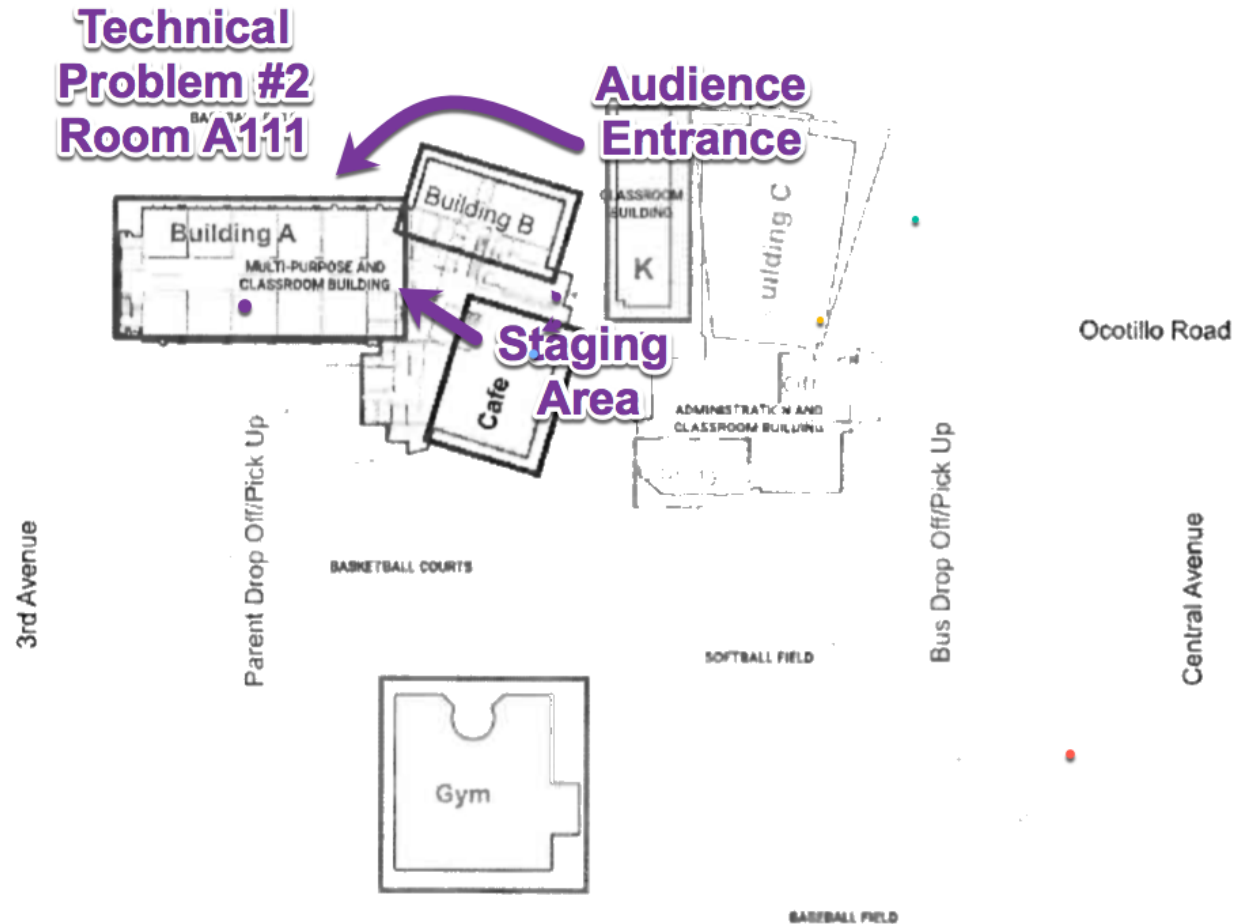

CLASSICS PROBLEM #3 - CLASSICS.... OPENING NIGHT ANTICS
Library

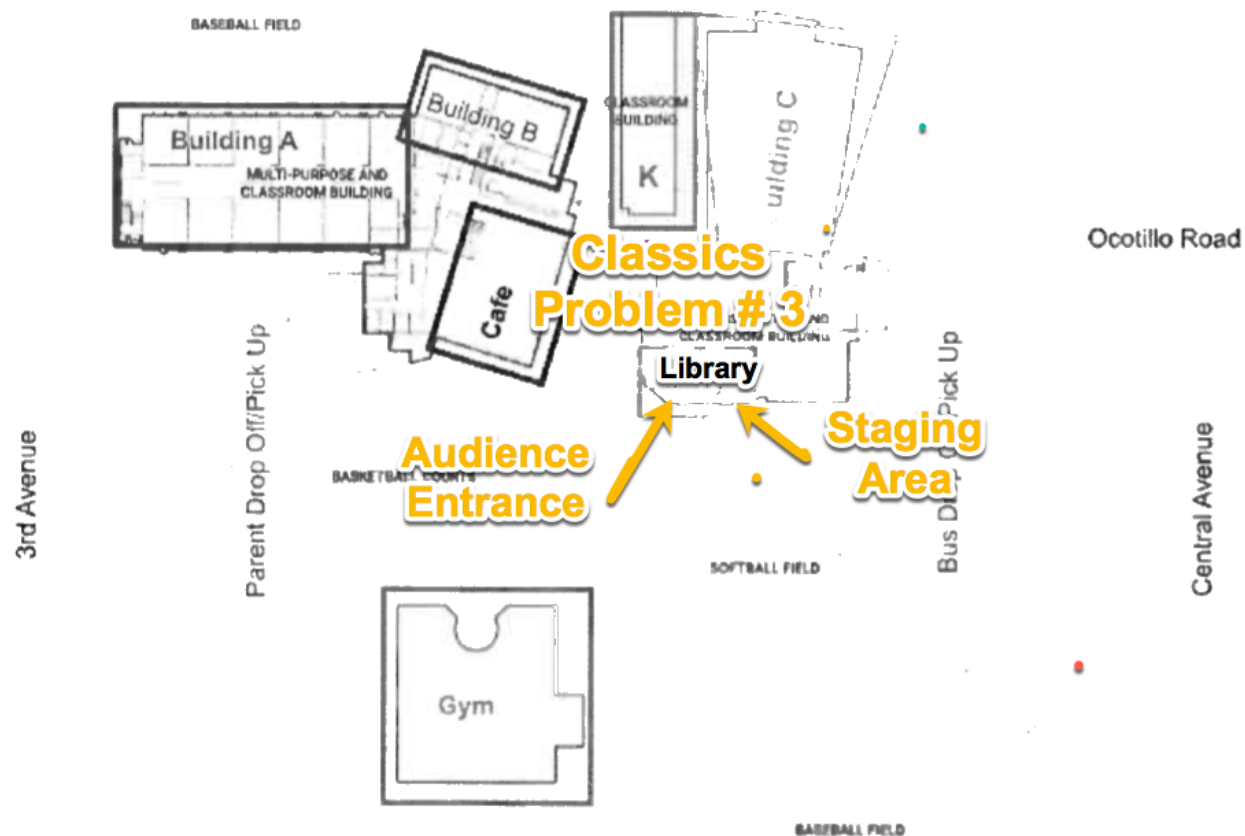

STRUCTURE PROBLEM #4 – DEEP SPACE STRUCTURE

Building K – K106

Weigh-In: Building C –Room C160 (room across from competition site)

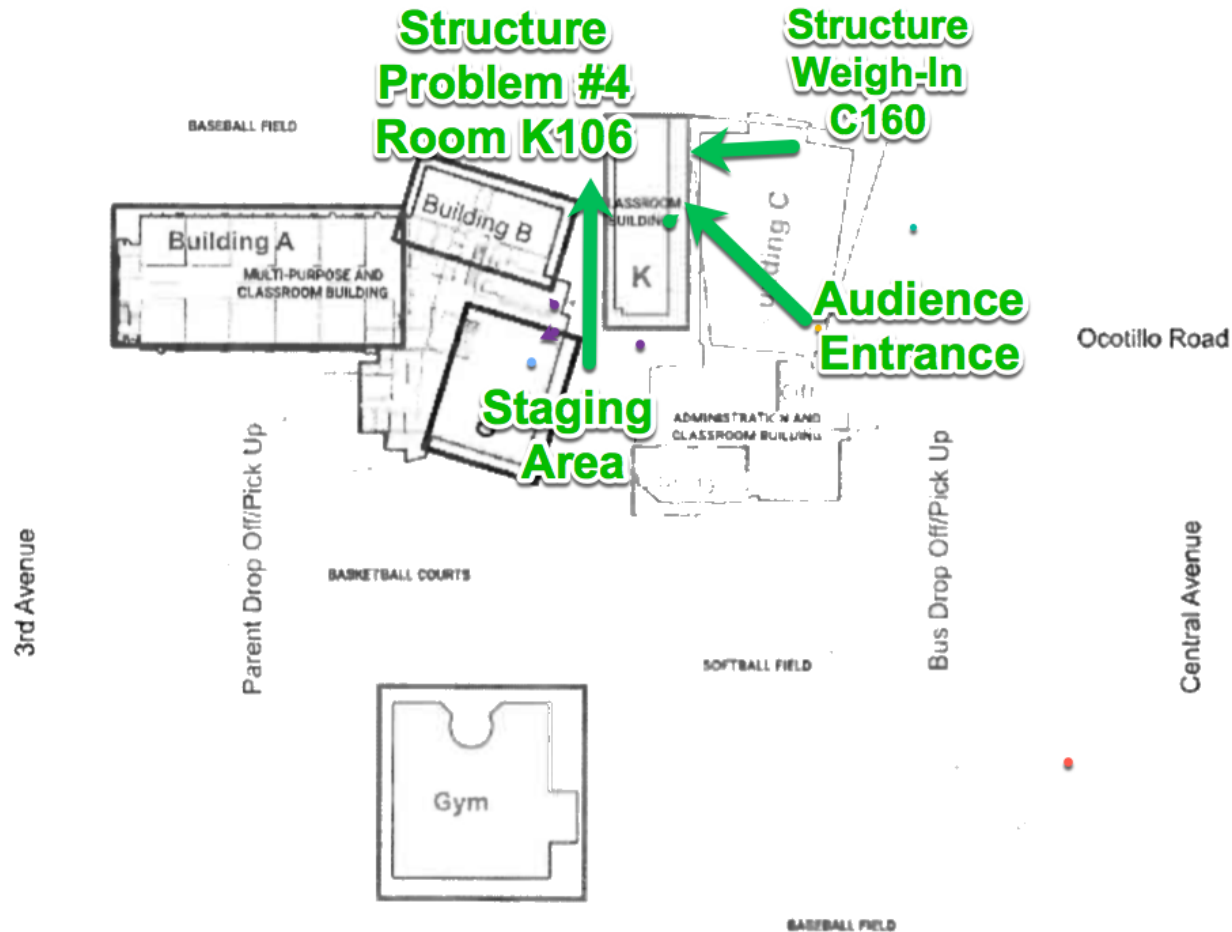

THEATRICALS PROBLEM #5 – ROCKING WORLD DETOUR
Building K – Room K103

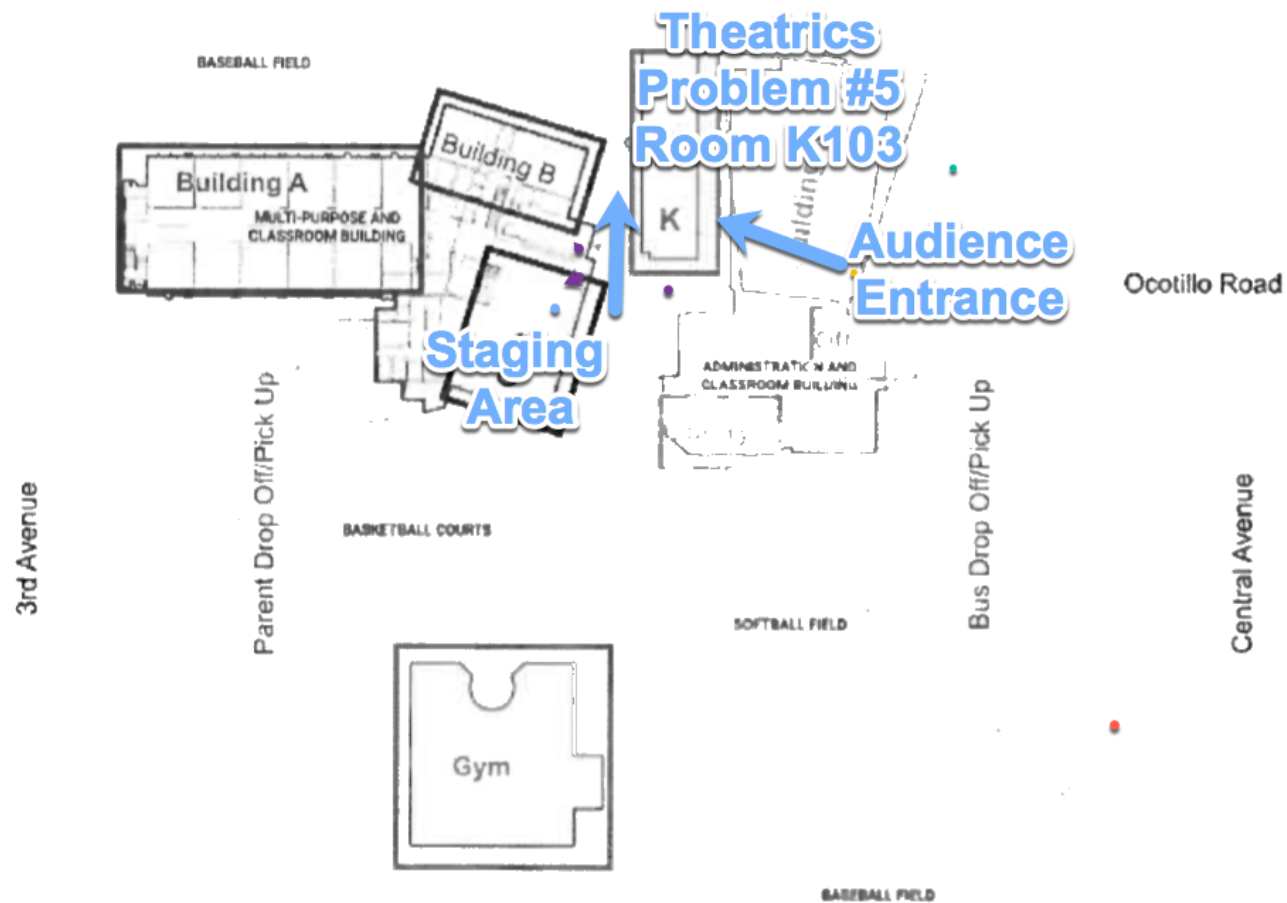

SPONTANEOUS COMPETITION – TEAMS ONLY

Building C – 2nd Floor

